



AT EVERY STEP OF THE WAY

Boomer Angle 400

P/N: 8100453

Tool Features

The Magswitch BoomerAngles offer virtually unlimited angles. With a rotating MagSquare at the end of each axis. Magswitch BoomerAngles offers not only a fixed 90 degree angle on the inside and outside, but are adjustable to any angle in between. Featuring the benefits of Magswitch including incredible power and precision control, Magswitch BoomerAngles are easy to use and can be used with larger and heavier steel.

WARNING!
DO NOT OPERATE UNLESS IN
CONTACT WITH FERROUS TARGET



Specifications

Max Breakaway *	400 lbs	181 kg
Full Saturation Thickness	0.1345 in	3.43 mm
2:1 Shear Working Load *	20 lbs	9 kg
Net Weight	6.6 lbs	3.0 kg
Overall Height	181 mm	
Magnetic Pole Footprint	64 mm x 41.26 mm	

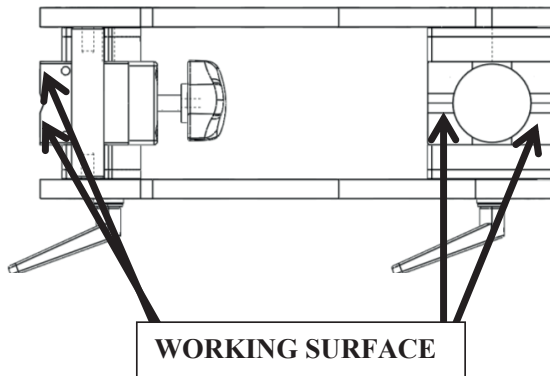

* Max Breakaway determined in laboratory environment on 2" thick SAE1018 Steel with surface roughness 63 micro inches. Many factors contribute to the actual breakaway force in each application. Always test the magswitch in each application before deployment. Refer to the magswitch information booklet for more information.



Magswitch Technologies | 1000 S. McCaslin Blvd.
Suite 301 | Superior | Colorado 80027
+1 (303) 468.0662 | sales@magswitch.com

MSA Magnetics | 14250 Judicial Road
Burnsville, MN | 55306 | 651-272-2950
sales@msamagnetics.com

BOOMER ANGLE 400
8100453

Doc Num 01

Subject to technical and color changes. No liability for errors and misprints assumed. © Magswitch Technologies 2024

Boomer Angle 400

P/N: 8100453

Drawings

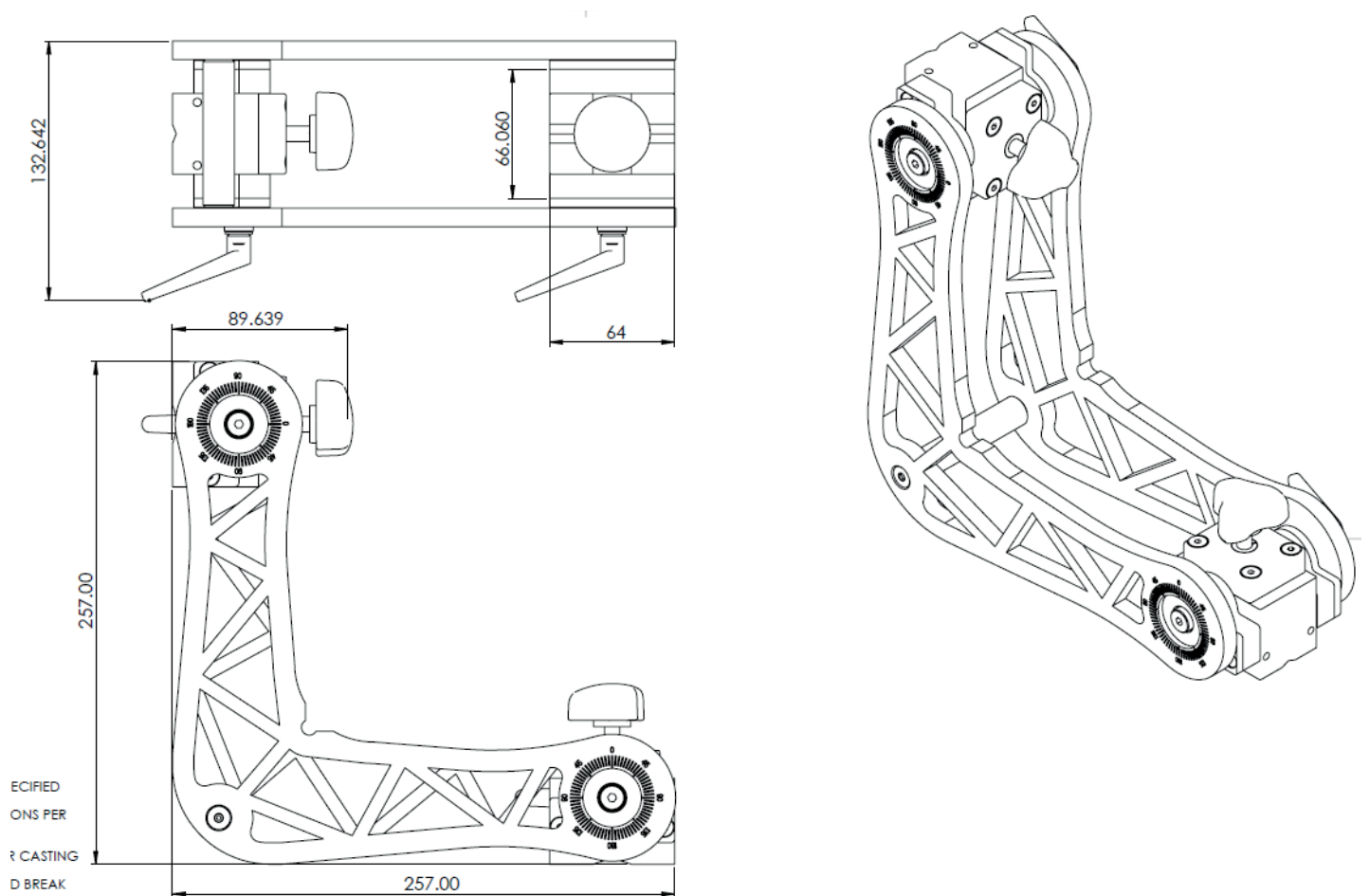

Magswitch Technologies | 1000 S. McCaslin Blvd.
Suite 301 | Superior | Colorado 80027
+1 (303) 468.0662 | sales@magswitch.com

MSA Magnetics | 14250 Judicial Road
Burnsville, MN | 55306 | 651-272-2950
sales@msamagnetics.com

BOOMER ANGLE 400
8100453

Doc Num 01

Subject to technical and color changes. No liability for errors and misprints assumed. © Magswitch Technologies 2024

Boomer Angle 400

P/N: 8100453

Breakaway Data

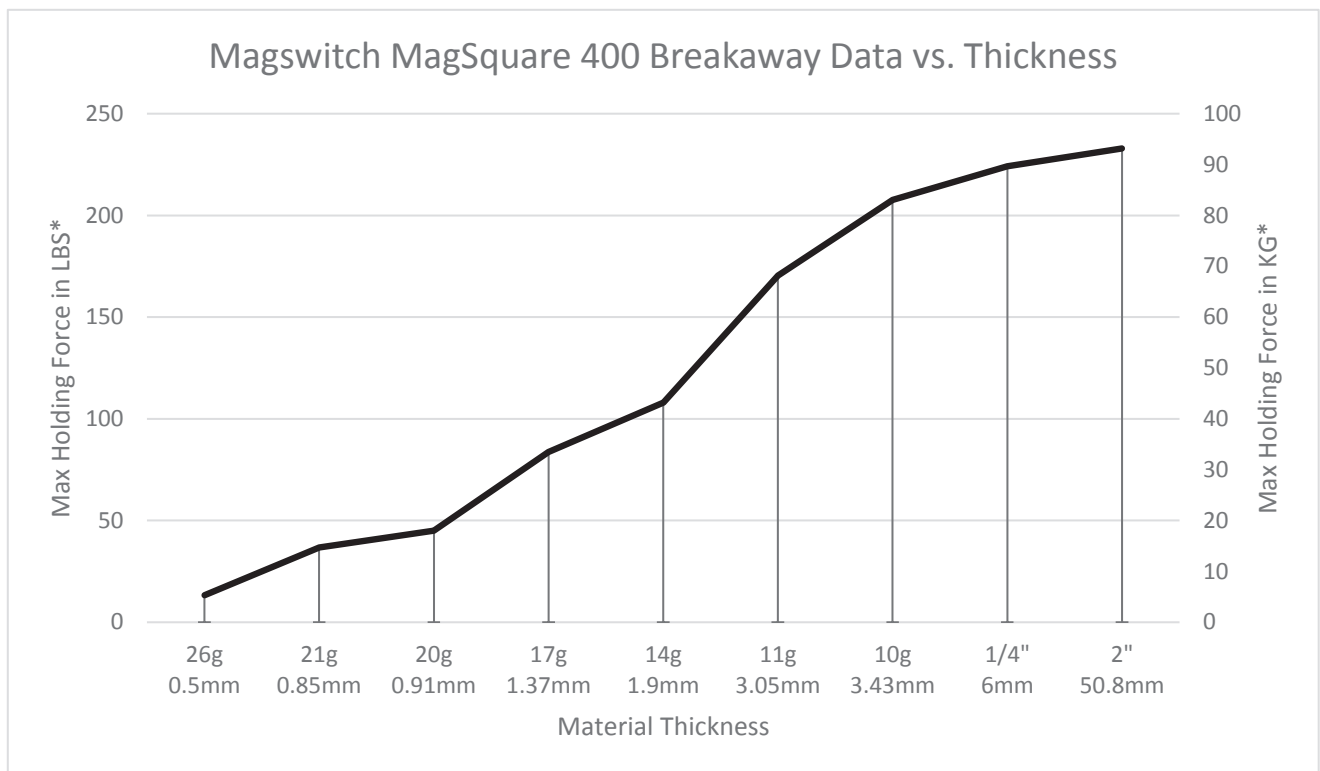

* Max Breakaway determined in laboratory environment on 2" thick SAE1018 Steel with surface roughness 63 micro inches. Many factors contribute to the actual breakaway force in each application. Always test the magswitch in each application before deployment. Refer to the magswitch information booklet for more information.



Magswitch Technologies | 1000 S. McCaslin Blvd.
Suite 301 | Superior | Colorado 80027
+1 (303) 468.0662 | sales@magswitch.com

MSA Magnetics | 14250 Judicial Road
Burnsville, MN | 55306 | 651-272-2950
sales@msamagnetics.com

BOOMER ANGLE 400
8100453

Doc Num 01

Subject to technical and color changes. No liability for errors and misprints assumed. © Magswitch Technologies 2024