



AT EVERY STEP OF THE WAY

Pivot Angle 150 Mini

P/N: 81001269

Tool Features

The Magswitch Pivot Angle offers a range of angles from 0 to 270 degrees. Each axis features a Magswitch with a 182lbs (82.6kg) hold capability. A single pivot point is located on the elbow. The elbow joint locks and unlocks quickly with a thumb screw. The dial on the elbow features indicators every 9 degrees. On each axis a Magswitch magnetic tool is exposed on a side to enable the tool to secure to a table or wall, while simultaneously holding the work piece. Perfect for repetitive work on uncommon angles.



WARNING!
DO NOT OPERATE UNLESS IN
CONTACT WITH FERROUS TARGET

Specifications

Maximum Breakaway Force ^{1,2,4}	182 lbs		83 kg	
Maximum Shear ^{1,2,4}	25.3 lbs		11 kg	
Full Saturation Thickness	3/16 in		4.8 mm	
Overall Height (Max)	2.1 in		53.4 mm	
Overall Length	6.1 in		155.5 mm	
Overall Width	2.6 in		66.0 mm	
Net Weight	3 lbs		1 kg	
Magnetic Pole Footprint	1.0 x 2.1 in		26.4 x 54 mm	

Material Thickness - mm (in)	1.0 (0.039)	2.0 (0.079)	3.0 (0.118)	4.0 (0.157)	5.0 (0.197)	6.0 (0.236)	50.0 (1.969)
Maximum Force ⁴ - kg (lbs)	18.3 (40)	38.7 (85)	62.7 (138)	76.0 (168)	82.5 (182)	82.6 (182)	82.6 (182)

1. Determined in laboratory environment on 2" thick SAE1018 Steel with surface roughness 63 micro inches with optimized pole shoes. Many factors contribute to the actual breakaway force and safe working load in each application. Consult a Magswitch Applications Engineer and test the Magswitch in each application before deployment.

2. All data applies to unit with flat pole shoes installed.

3. Values may vary by +/- 5%.

4. Maximum forces listed above are not safe lifting forces. Designer must take into account safety factor when specifying tool. Magswitch recommends SWL = 5:1 for most applications.



Magswitch Technologies | 1000 S. McCaslin Blvd.
Suite 301 | Superior | Colorado 80027
+1 (303) 468.0662 | sales@magswitch.com

MSA Magnetics | 4 Prince of Wales Ave
Unanderra NSW | 2526 | +61 2 4272 8180
sales@msamagnetics.com.au

PIVOT ANGLE 150 MINI
81001269

Doc Num 01

Subject to technical and color changes. No liability for errors and misprints assumed. © Magswitch Technologies 2024

Pivot Angle 150 Mini

P/N: 81001269

Drawings

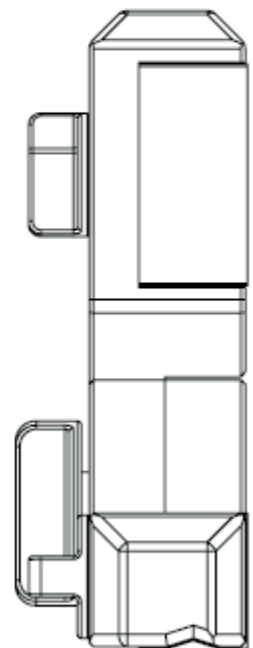
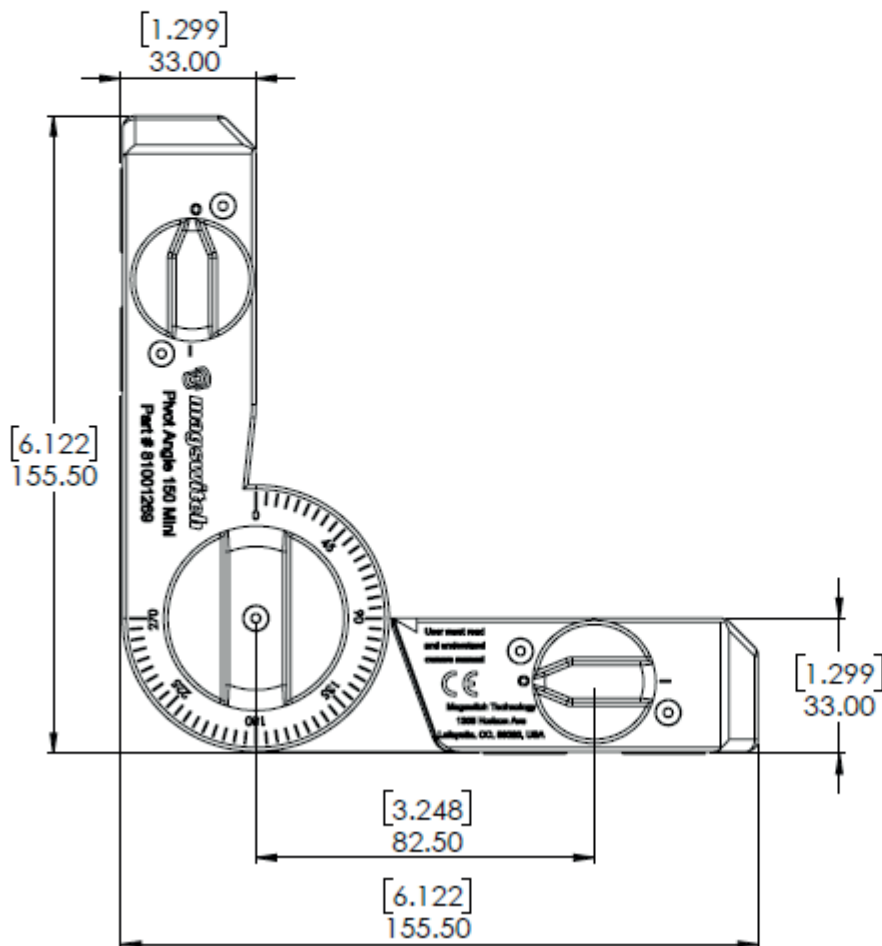
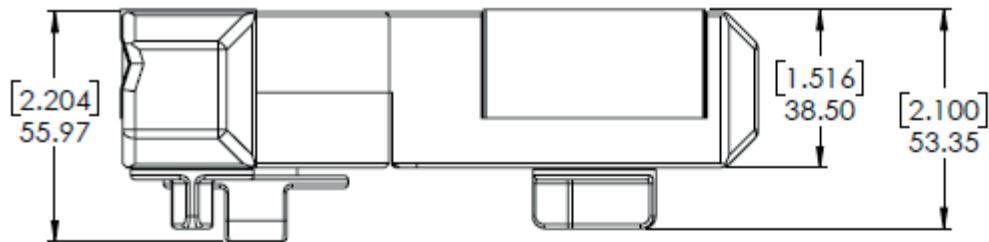

Magswitch Technologies | 1000 S. McCaslin Blvd.
Suite 301 | Superior | Colorado 80027
+1 (303) 468.0662 | sales@magswitch.com

MSA Magnetix | 4 Prince of Wales Ave
Unanderra NSW | 2526 | +61 2 4272 8180
sales@msamagnetix.com.au

PIVOT ANGLE 150 MINI
81001269

Doc Num 01

Subject to technical and color changes. No liability for errors and misprints assumed. © Magswitch Technologies 2024