



AT EVERY STEP OF THE WAY

# MLAY1000

P/N: 8100088

## Tool Features

Magswitch MLAY series magnets utilize different size magnets to attain different field depths. The MLAY1000 series utilizes 70mm magnets to achieve full saturation at 1/2 inch and greater. The MLAY1000 is a medium duty lifting magnet ideal for fitting in tight spots and lifting beams and medium sheets. This unit is great for lifting loads with painted or rusty surfaces as the deep field penetrates further into the metal.

**WARNING!**  
**DO NOT OPERATE UNLESS IN**  
**CONTACT WITH FERROUS TARGET**



## Specifications

Max Breakaway *	1000 lbs	454 kg
Safe Working Load *	333 lbs	151 kg
Full Saturation Thickness	1/2"	12.7mm
Max Safe Shear *	50 lbs	22.7 kg
Minimum Thickness for De-Stack	3/4"	12.7mm
Net Weight	11.5 lbs	5.2 kg
Overall Height	253.12 mm	
Magnetic Pole Footprint	108.0 x 72.0 mm	

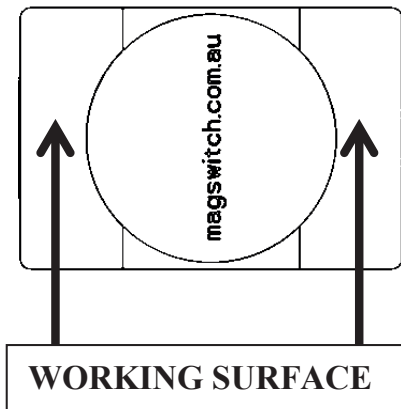

\* Max Breakaway determined in laboratory environment on 2" thick SAE1018 Steel with surface roughness 63 micro inches. Many factors contribute to the actual breakaway force in each application. Always test the magswitch in each application before deployment. Refer to the magswitch information booklet for more information.



Magswitch Technologies | 1000 S. McCaslin Blvd.  
Suite 301 | Superior | Colorado 80027  
+1 (303) 468.0662 | sales@magswitch.com

MSA Magnetics | 4 Prince of Wales Ave  
Unanderra NSW | 2526 | +61 2 4272 8180  
sales@msamagnetics.com.au

**MLAY1000**  
**8100088**

Doc Num 01

Subject to technical and color changes. No liability for errors and misprints assumed. © Magswitch Technologies 2024

# MLAY1000

P/N: 8100088

## Drawings

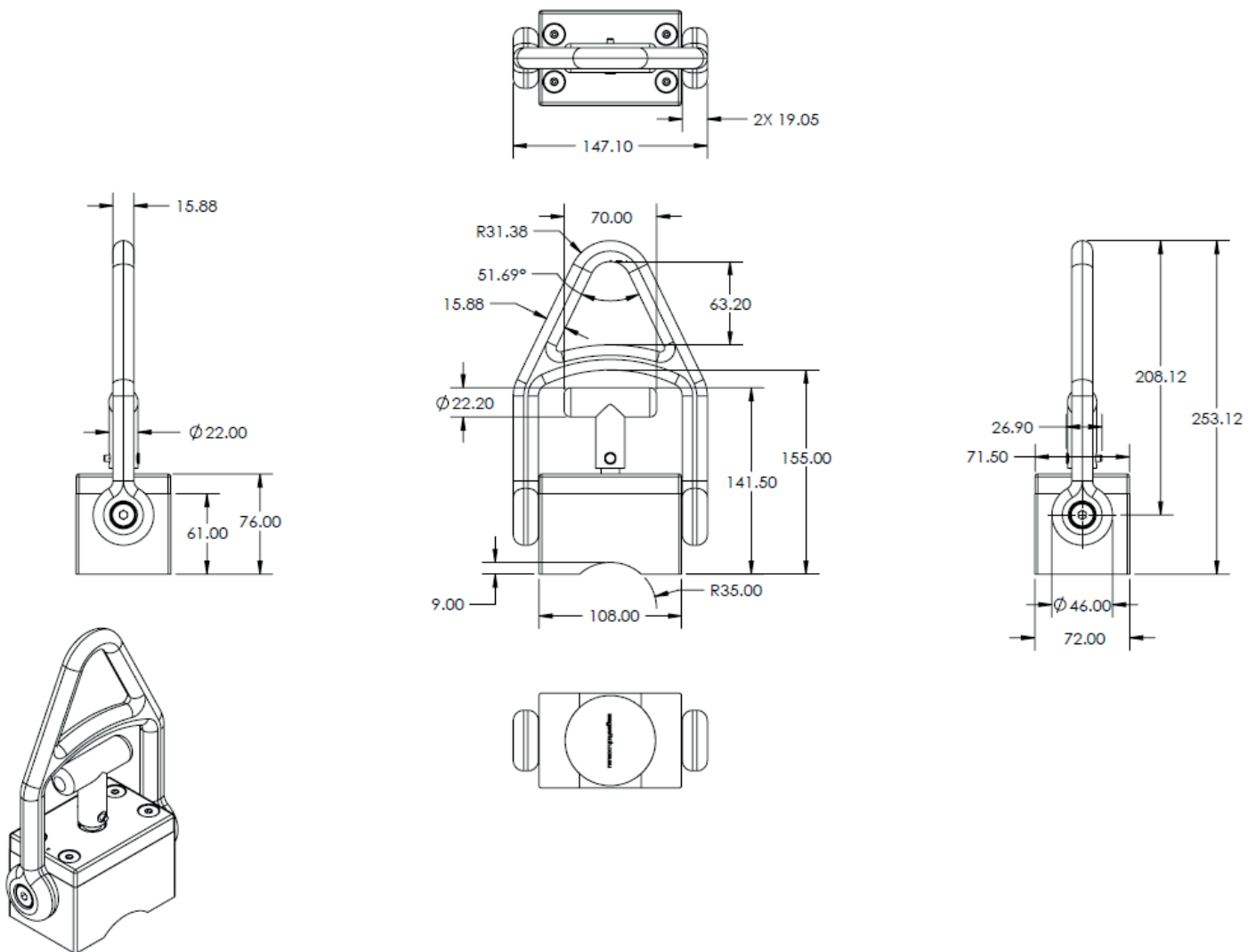

Magswitch Technologies | 1000 S. McCaslin Blvd.  
Suite 301 | Superior | Colorado 80027  
+1 (303) 468.0662 | sales@magswitch.com

MSA Magnetics | 4 Prince of Wales Ave  
Unanderra NSW | 2526 | +61 2 4272 8180  
sales@msamagnetics.com.au

**MLAY1000**  
**8100088**

Doc Num 01

Subject to technical and color changes. No liability for errors and misprints assumed. © Magswitch Technologies 2024

# MLAY1000

P/N: 8100088

## Safe Working Load

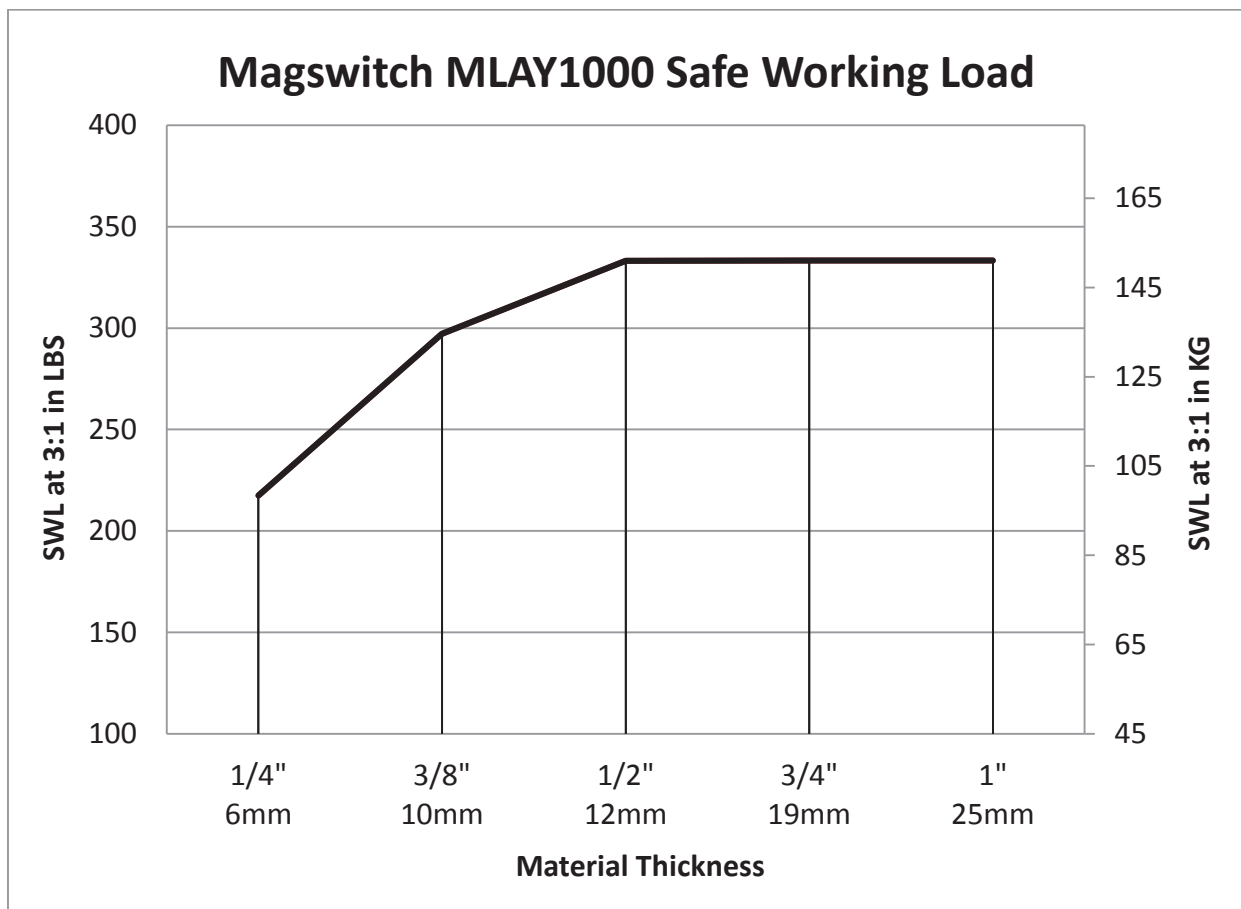

Magswitch Technologies | 1000 S. McCaslin Blvd.  
Suite 301 | Superior | Colorado 80027  
+1 (303) 468.0662 | [sales@magswitch.com](mailto:sales@magswitch.com)

MSA Magnetix | 4 Prince of Wales Ave  
Unanderra NSW | 2526 | +61 2 4272 8180  
[sales@msamagnetix.com.au](mailto:sales@msamagnetix.com.au)

**MLAY1000**  
**8100088**

Doc Num 01

Subject to technical and color changes. No liability for errors and misprints assumed. © Magswitch Technologies 2024