



AT EVERY STEP OF THE WAY

MLAY600x2

P/N: 8100360

Tool Features

Magswitch MLAY series magnets utilize different size magnets to attain a certain field depth or saturation of magnetic field. This allows for greater working loads and increased control over larger work pieces. The MLAY600x2 is a lightweight heavy lifting magnet ideal for fitting in tight spots and lifting thin sheet. It features a unique single swivel hook for lifting from horizontal to vertical. With customizable pole shoes to fit almost any application, the MLAY is a great all around tool that is perfect for picking pipe and round as well as large plate steel.



WARNING!
DO NOT OPERATE UNLESS IN
CONTACT WITH FERROUS TARGET

Specifications

Max Breakaway *	1100 lbs	500 kg
Safe Working Load *	367 lbs	167 kg
Full Saturation Thickness	1/2"	9.5mm
Max Safe Shear *	200 lbs	90.9 kg
Minimum Thickness for De-Stack	1/2"	9.5mm
Net Weight	9.5 lbs	4.3 kg
Mounting Thread	M6x1.0	
Overall Height	170.9 mm	
Magnetic Pole Footprint	119x71.12 mm	

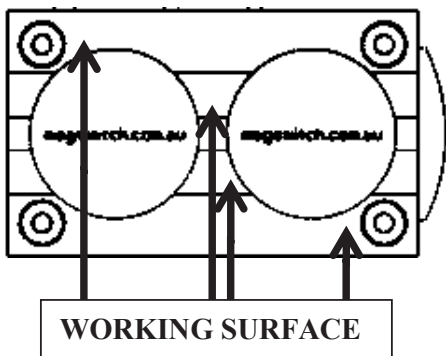

* Max Breakaway determined in laboratory environment on 2" thick SAE1018 Steel with surface roughness 63 micro inches. Many factors contribute to the actual breakaway force in each application. Always test the magswitch in each application before deployment. Refer to the magswitch information booklet for more information.



Magswitch Technologies | 1000 S. McCaslin Blvd.
Suite 301 | Superior | Colorado 80027
+1 (303) 468.0662 | sales@magswitch.com

MSA Magnetix | 4 Prince of Wales Ave
Unanderra NSW | 2526 | +61 2 4272 8180
sales@msamagnetix.com.au

MLAY600x2
8100360

Doc Num 01

Subject to technical and color changes. No liability for errors and misprints assumed. © Magswitch Technologies 2024

MLAY600x2

P/N: 8100360

Drawings

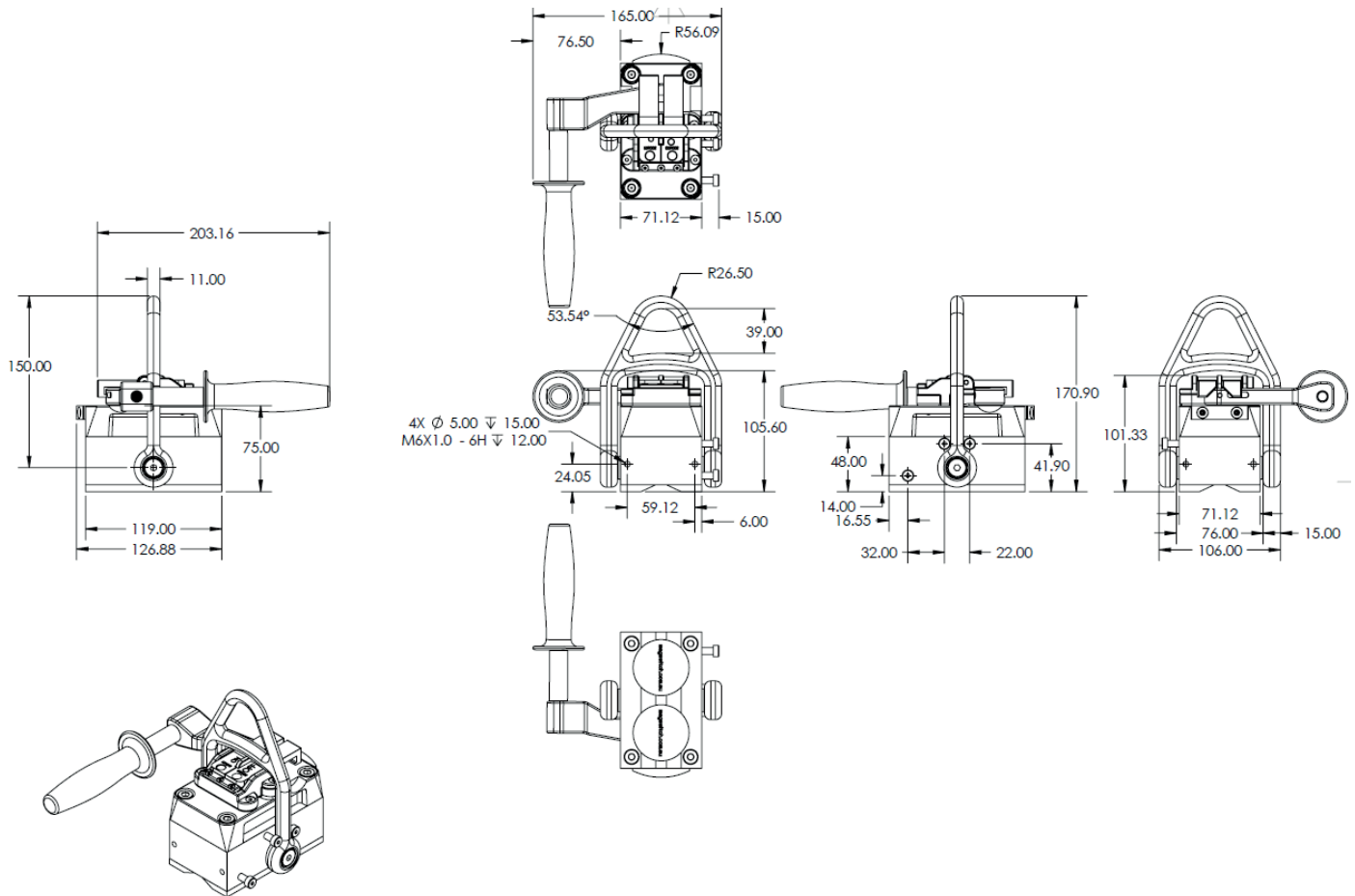

Magswitch Technologies | 1000 S. McCaslin Blvd.
Suite 301 | Superior | Colorado 80027
+1 (303) 468.0662 | sales@magswitch.com

MSA Magnetics | 4 Prince of Wales Ave
Unanderra NSW | 2526 | +61 2 4272 8180
sales@msamagnetics.com.au

MLAY600x2
8100360

Doc Num 01

Subject to technical and color changes. No liability for errors and misprints assumed. © Magswitch Technologies 2024

MLAY600x2

P/N: 8100360

Safe Working Load

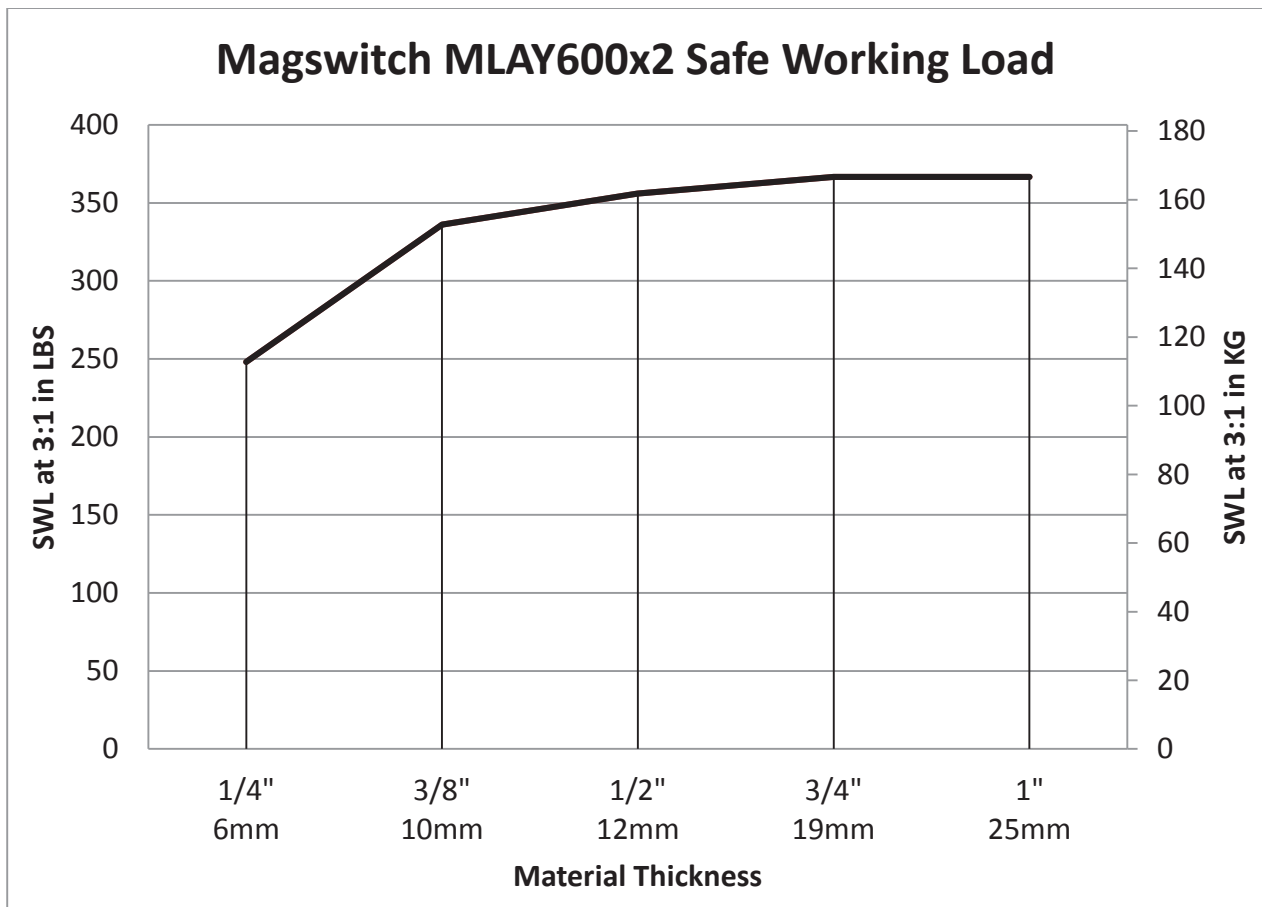

Magswitch Technologies | 1000 S. McCaslin Blvd.
Suite 301 | Superior | Colorado 80027
+1 (303) 468.0662 | sales@magswitch.com

MSA Magnetics | 4 Prince of Wales Ave
Unanderra NSW | 2526 | +61 2 4272 8180
sales@msamagnetics.com.au

MLAY600x2
8100360

Doc Num 01

Subject to technical and color changes. No liability for errors and misprints assumed. © Magswitch Technologies 2024