



AT EVERY STEP OF THE WAY

## Hand Lifter - 60 CE

P/N: 8800487

### Tool Features

Magswitch “M” series actuated units are designed around an optimized housing that allows for greater breakaway force in a compact design that outperforms other magnets of a similar size. The “M” series is the perfect tool for gripping flat sections of steel.

**WARNING!**  
**DO NOT OPERATE UNLESS IN**  
**CONTACT WITH FERROUS TARGET**



### Specifications

Max Breakaway *	197 lbs	89.4 kg
Safe Working Load *	66 lbs	30 kg
Full Saturation Thickness	1/4"	6.35 mm
Max Safe Shear *	45 lbs	20.4 kg
Minimum Thickness for De-Stack	1/4"	6.35 mm
Net Weight	1.1 kg	
Overall Height	209.3 mm	
Magnetic Pole Footprint	56 x 42 mm	

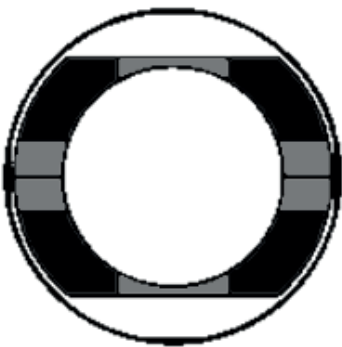

**WORKING SURFACE**  
**BLACK = BEST**  
**GRAY = MODERATE**

\* Max Breakaway determined in laboratory environment on 2" thick SAE1018 Steel with surface roughness 63 micro inches. Many factors contribute to the actual breakaway force in each application. Always test the magswitch in each application before deployment. Refer to the magswitch information booklet for more information.



Magswitch Technologies | 1000 S. McCaslin Blvd.  
Suite 301 | Superior | Colorado 80027  
+1 (303) 468.0662 | sales@magswitch.com

MSA Magnetics | 14250 Judicial Road  
Burnsville, MN | 55306 | 651-272-295  
sales@msamagnetics.com

**HAND LIFTER - 60 CE**  
**8800487**

Doc Num 01

Subject to technical and color changes. No liability for errors and misprints assumed. © Magswitch Technologies 2024

# Hand Lifter - 60 CE

P/N: 8800487

## Drawings

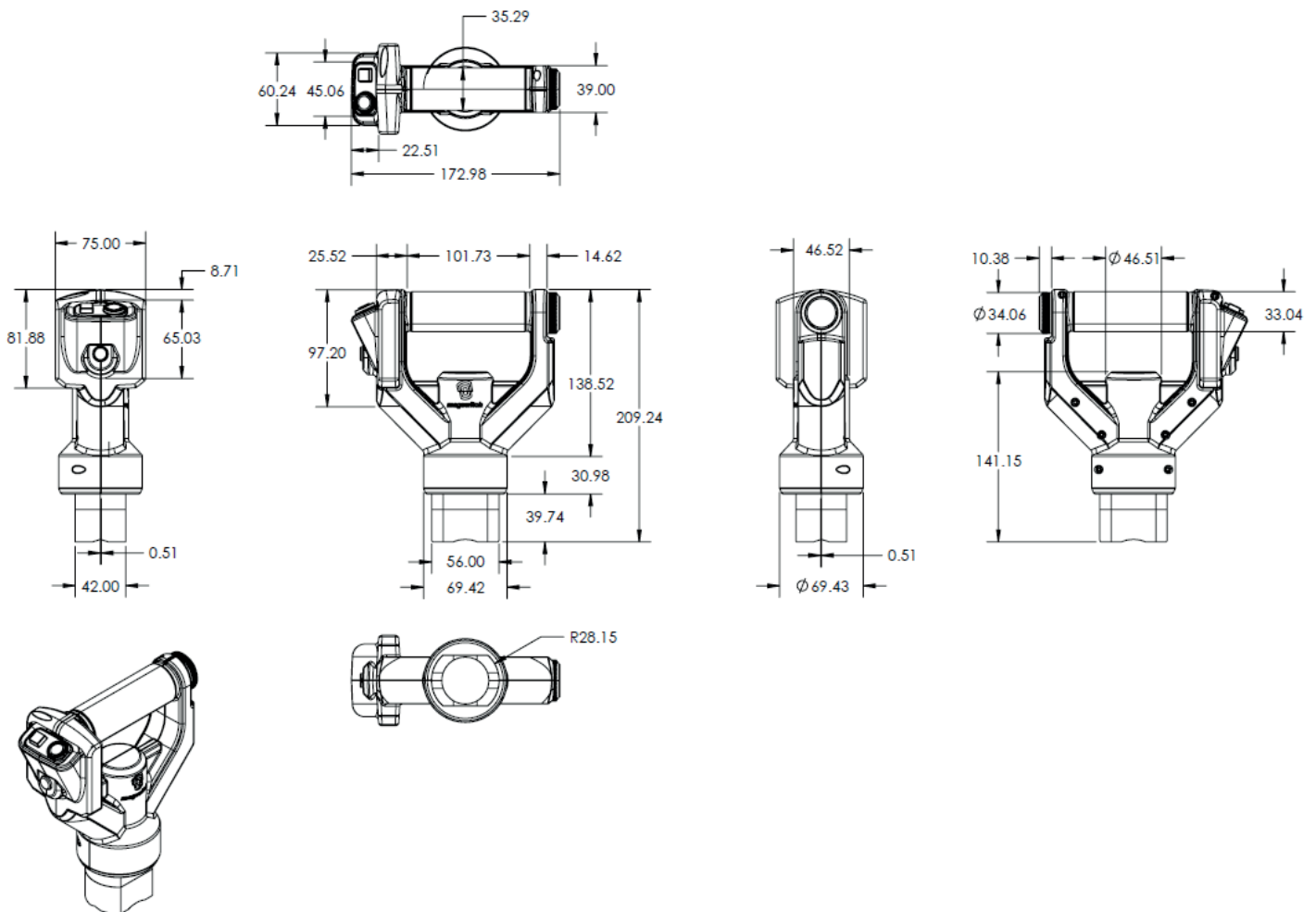

Magswitch Technologies | 1000 S. McCaslin Blvd.  
Suite 301 | Superior | Colorado 80027  
+1 (303) 468.0662 | sales@magswitch.com

MSA Magnetics | 14250 Judicial Road  
Burnsville, MN | 55306 | 651-272-295  
sales@msamagnetics.com

**HAND LIFTER - 60 CE**  
**8800487**

Doc Num 01

Subject to technical and color changes. No liability for errors and misprints assumed. © Magswitch Technologies 2024

# Hand Lifter - 60 CE

P/N: 8800487

## Safe Working Load

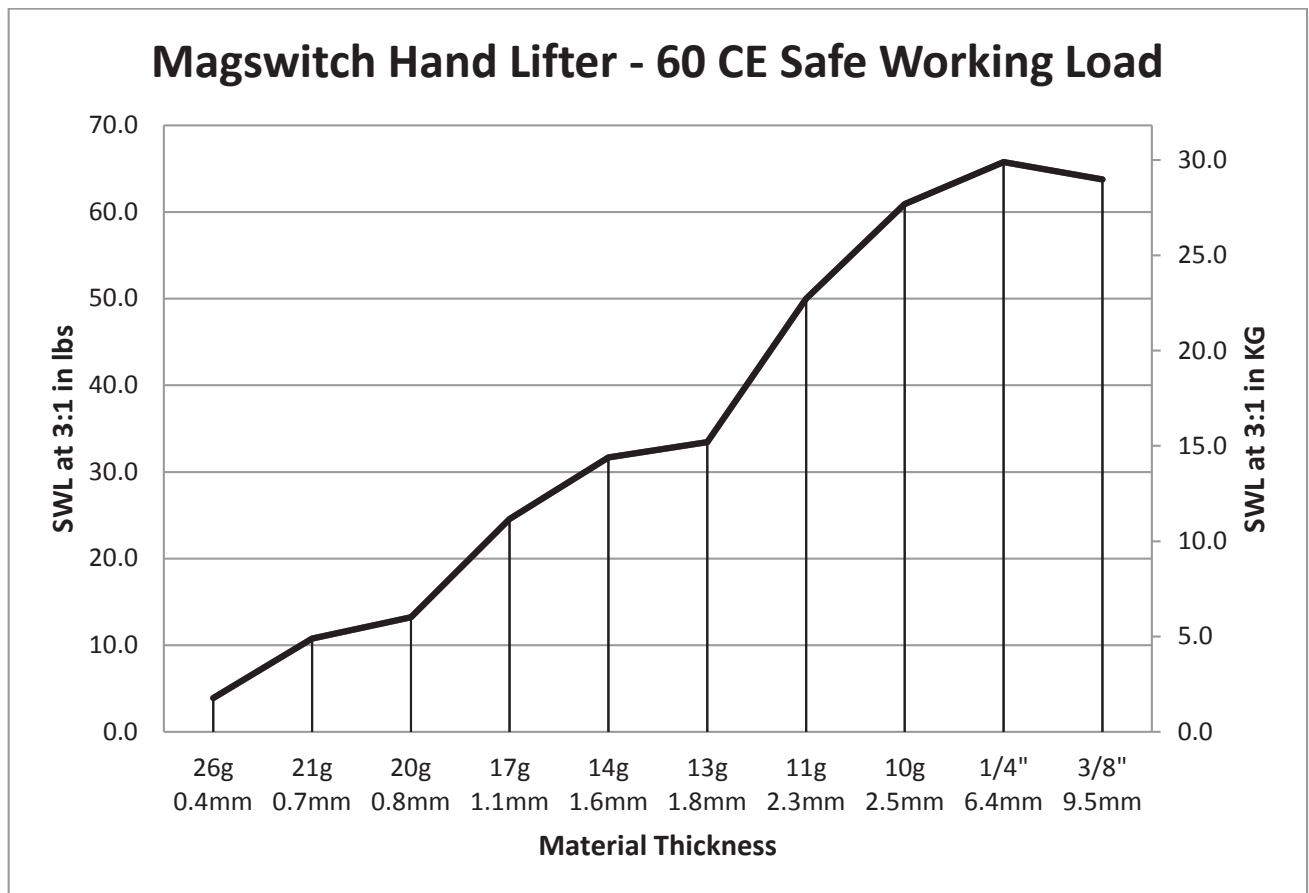

Magswitch Technologies | 1000 S. McCaslin Blvd.  
Suite 301 | Superior | Colorado 80027  
+1 (303) 468.0662 | [sales@magswitch.com](mailto:sales@magswitch.com)

MSA Magnetics | 14250 Judicial Road  
Burnsville, MN | 55306 | 651-272-295  
[sales@msamagnetics.com](mailto:sales@msamagnetics.com)

**HAND LIFTER - 60 CE**  
**8800487**

Doc Num 01

Subject to technical and color changes. No liability for errors and misprints assumed. © Magswitch Technologies 2024