



AT EVERY STEP OF THE WAY

MLAY1000

P/N: 8100088

Tool Features

Magswitch MLAY series magnets utilize different size magnets to attain different field depths. The MLAY1000 series utilizes 70mm magnets to achieve full saturation at 1/2 inch and greater. The MLAY1000 is a medium duty lifting magnet ideal for fitting in tight spots and lifting beams and medium sheets. This unit is great for lifting loads with painted or rusty surfaces as the deep field penetrates further into the metal.

WARNING!
DO NOT OPERATE UNLESS IN
CONTACT WITH FERROUS TARGET



Specifications

Max Breakaway *	1000 lbs	454 kg
Safe Working Load *	333 lbs	151 kg
Full Saturation Thickness	1/2"	12.7mm
Max Safe Shear *	50 lbs	22.7 kg
Minimum Thickness for De-Stack	3/4"	12.7mm
Net Weight	11.5 lbs	5.2 kg
Overall Height	253.12 mm	
Magnetic Pole Footprint	108.0 x 72.0 mm	

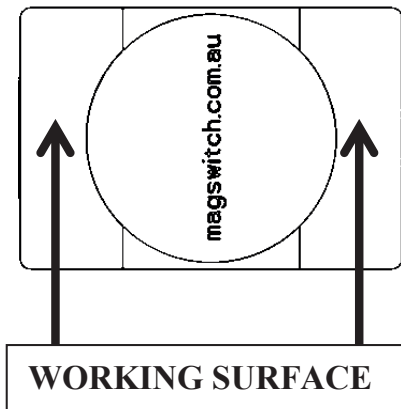

* Max Breakaway determined in laboratory environment on 2" thick SAE1018 Steel with surface roughness 63 micro inches. Many factors contribute to the actual breakaway force in each application. Always test the magswitch in each application before deployment. Refer to the magswitch information booklet for more information.



Magswitch Technologies | 1000 S. McCaslin Blvd.
Suite 301 | Superior | Colorado 80027
+1 (303) 468.0662 | sales@magswitch.com

MSA Magnetix | 14250 Judicial Road
Burnsville, MN | 55306 | 651-272-2950
sales@msamagnetix.com

MLAY1000
8100088

Doc Num 01

Subject to technical and color changes. No liability for errors and misprints assumed. © Magswitch Technologies 2024

MLAY1000

P/N: 8100088

Drawings

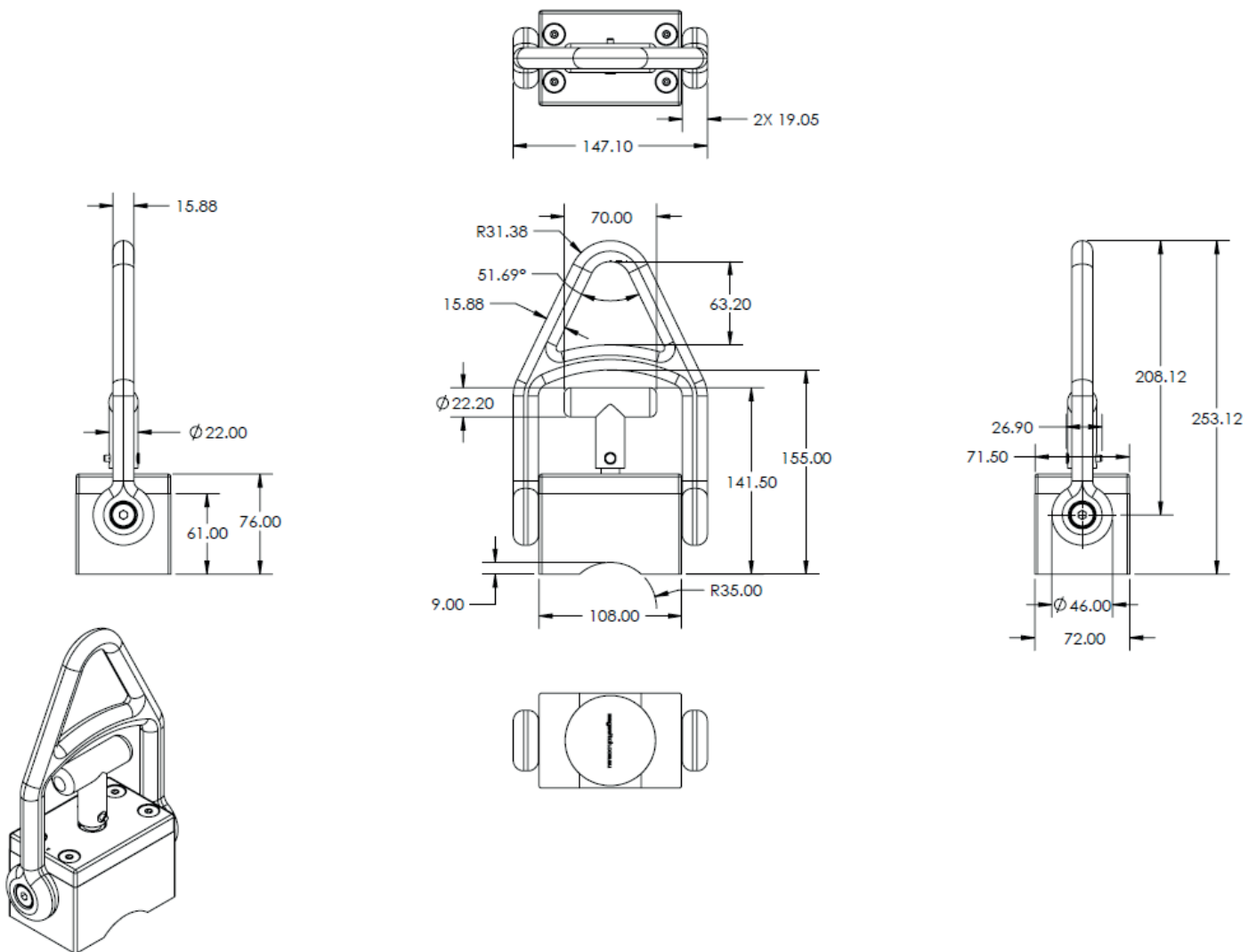

Magswitch Technologies | 1000 S. McCaslin Blvd.
Suite 301 | Superior | Colorado 80027
+1 (303) 468.0662 | sales@magswitch.com

MSA Magnetics | 14250 Judicial Road
Burnsville, MN | 55306 | 651-272-2950
sales@msamagnetics.com

MLAY1000
8100088

Doc Num 01

Subject to technical and color changes. No liability for errors and misprints assumed. © Magswitch Technologies 2024

MLAY1000

P/N: 8100088

Safe Working Load

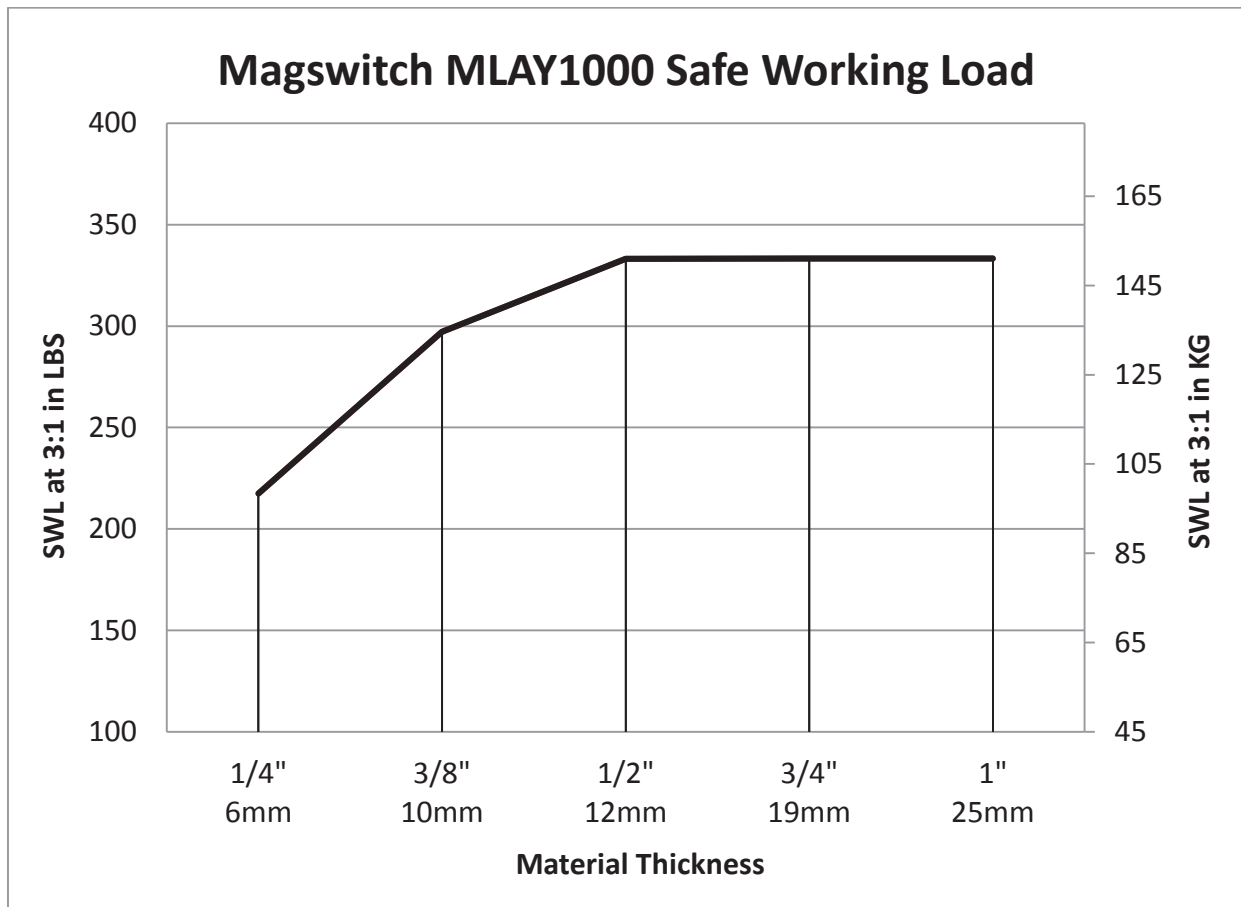

Magswitch Technologies | 1000 S. McCaslin Blvd.
Suite 301 | Superior | Colorado 80027
+1 (303) 468.0662 | sales@magswitch.com

MSA Magnetics | 14250 Judicial Road
Burnsville, MN | 55306 | 651-272-2950
sales@msamagnetics.com

MLAY1000
8100088

Doc Num 01

Subject to technical and color changes. No liability for errors and misprints assumed. © Magswitch Technologies 2024