



AT EVERY STEP OF THE WAY

MLAY1000x3

P/N: 8100403

Tool Features

Magswitch MLAY series magnets utilize different size magnets to attain different field depths. This allows for greater working loads and increased control over larger work pieces. The MLAY1000x3 is a lightweight heavy lifting magnet ideal for lifting thick sheet, beams, pipe, and performs well on air gaps such as rust and dirt. It features a unique dual swivel hook design for both load stability and lifting from horizontal to vertical. With customizable pole shoes to fit almost any application, the MLAY is a great all around tool that is perfect for picking pipe and round as well as large plate steel.

WARNING!
DO NOT OPERATE UNLESS IN
CONTACT WITH FERROUS TARGET



Specifications

Max Breakaway *	2733 lbs	1242 kg
Safe Working Load *	911 lbs	414 kg
Full Saturation Thickness	3/4"	19.05mm
Max Safe Shear *	198 lbs	90 kg
Minimum Thickness for De-Stack	3/4"	19.05mm
Net Weight	36.5 lbs	16.6 kg
Mounting Thread	M8x1.25	
Overall Height	264.52 mm	
Magnetic Pole Footprint	255.0x97.6 mm	

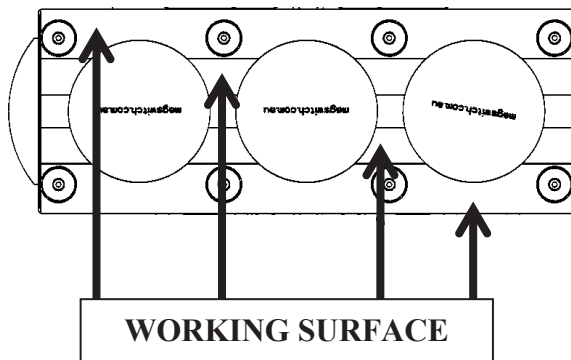

* Max Breakaway determined in laboratory environment on 2" thick SAE1018 Steel with surface roughness 63 micro inches. Many factors contribute to the actual breakaway force in each application. Always test the magswitch in each application before deployment. Refer to the magswitch information booklet for more information.



MLAY1000x3
8100403

Magswitch Technologies | 1000 S. McCaslin Blvd.
Suite 301 | Superior | Colorado 80027
+1 (303) 468.0662 | sales@magswitch.com

MSA Magnetix | 14250 Judicial Road
Burnsville, MN | 55306 | 651-272-2950
sales@msamagnetix.com

Doc Num 01

Subject to technical and color changes. No liability for errors and misprints assumed. © Magswitch Technologies 2024

MLAY1000x3

P/N: 8100403

Drawings

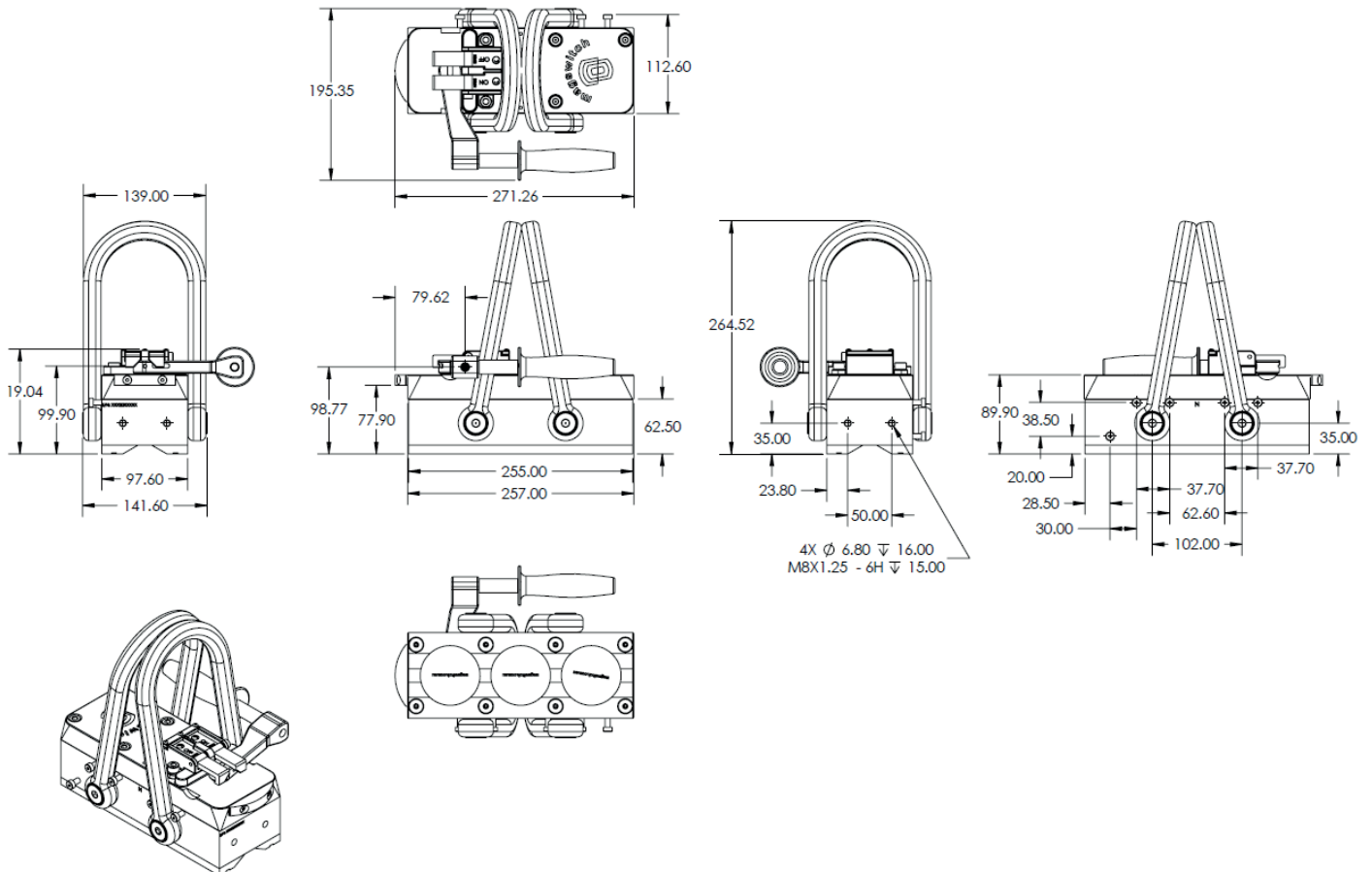

Magswitch Technologies | 1000 S. McCaslin Blvd.
Suite 301 | Superior | Colorado 80027
+1 (303) 468.0662 | sales@magswitch.com

MSA Magnetics | 14250 Judicial Road
Burnsville, MN | 55306 | 651-272-2950
sales@msamagnetics.com

MLAY1000x3
8100403

Doc Num 01

Subject to technical and color changes. No liability for errors and misprints assumed. © Magswitch Technologies 2024

MLAY1000x3

P/N: 8100403

Safe Working Load

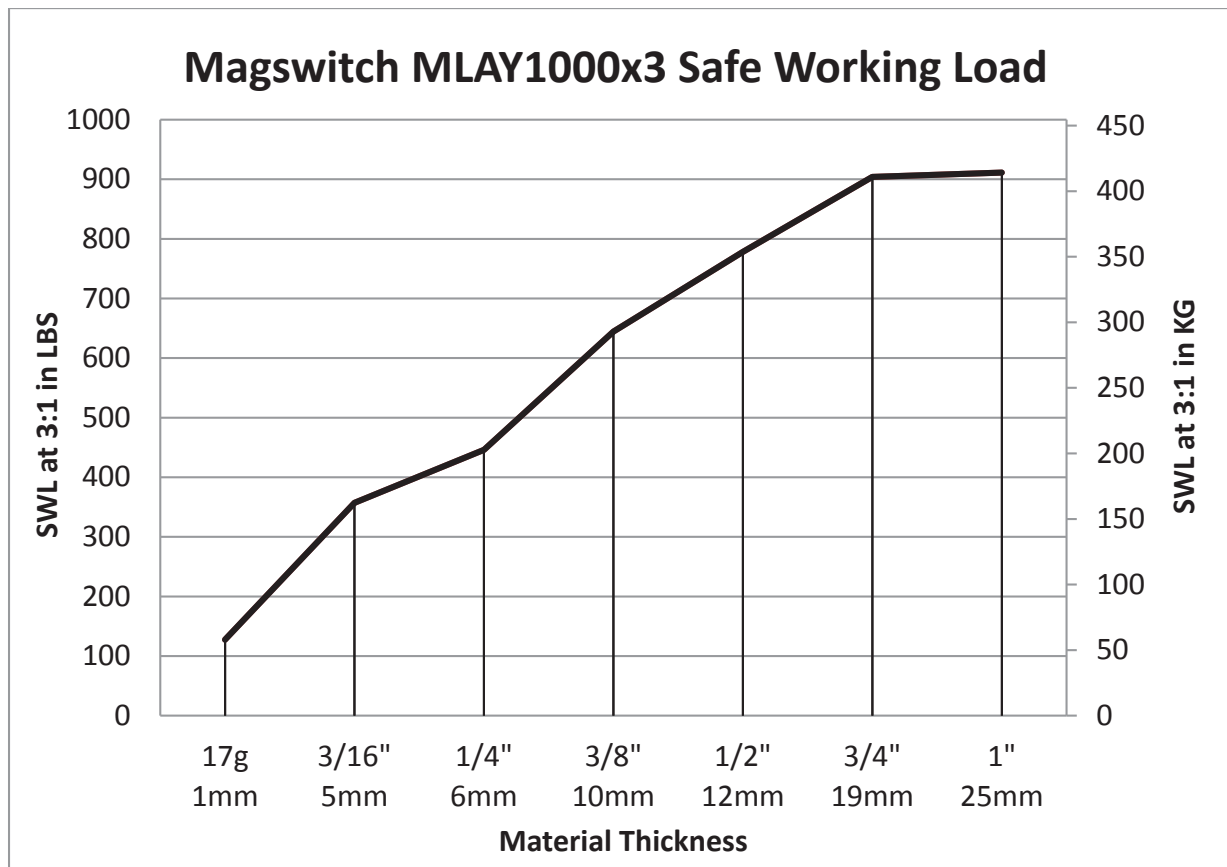

Magswitch Technologies | 1000 S. McCaslin Blvd.
Suite 301 | Superior | Colorado 80027
+1 (303) 468.0662 | sales@magswitch.com

MSA Magnetics | 14250 Judicial Road
Burnsville, MN | 55306 | 651-272-2950
sales@msamagnetics.com

MLAY1000x3
8100403

Doc Num 01

Subject to technical and color changes. No liability for errors and misprints assumed. © Magswitch Technologies 2024