



AT EVERY STEP OF THE WAY

## MLAY600x2

P/N: 8100360

### Tool Features

Magswitch MLAY series magnets utilize different size magnets to attain a certain field depth or saturation of magnetic field. This allows for greater working loads and increased control over larger work pieces. The MLAY600x2 is a lightweight heavy lifting magnet ideal for fitting in tight spots and lifting thin sheet. It features a unique single swivel hook for lifting from horizontal to vertical. With customizable pole shoes to fit almost any application, the MLAY is a great all around tool that is perfect for picking pipe and round as well as large plate steel.



**WARNING!**  
**DO NOT OPERATE UNLESS IN**  
**CONTACT WITH FERROUS TARGET**

### Specifications

|                                |              |         |
|--------------------------------|--------------|---------|
| Max Breakaway *                | 1100 lbs     | 500 kg  |
| Safe Working Load *            | 367 lbs      | 167 kg  |
| Full Saturation Thickness      | 1/2"         | 9.5mm   |
| Max Safe Shear *               | 200 lbs      | 90.9 kg |
| Minimum Thickness for De-Stack | 1/2"         | 9.5mm   |
| Net Weight                     | 9.5 lbs      | 4.3 kg  |
| Mounting Thread                | M6x1.0       |         |
| Overall Height                 | 170.9 mm     |         |
| Magnetic Pole Footprint        | 119x71.12 mm |         |

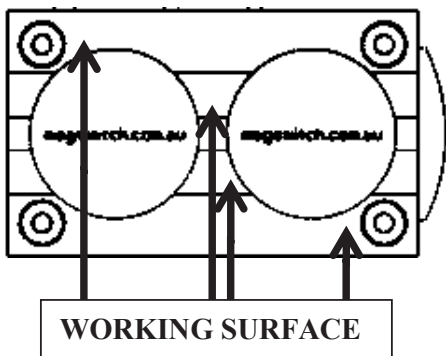

\* Max Breakaway determined in laboratory environment on 2" thick SAE1018 Steel with surface roughness 63 micro inches. Many factors contribute to the actual breakaway force in each application. Always test the magswitch in each application before deployment. Refer to the magswitch information booklet for more information.



Magswitch Technologies | 1000 S. McCaslin Blvd.  
Suite 301 | Superior | Colorado 80027  
+1 (303) 468.0662 | sales@magswitch.com

MSA Magnetix | 14250 Judicial Road  
Burnsville, MN | 55306 | 651-272-2950  
sales@msamagnetix.com

**MLAY600x2**  
**8100360**

Doc Num 01

Subject to technical and color changes. No liability for errors and misprints assumed. © Magswitch Technologies 2024

# MLAY600x2

P/N: 8100360

## Drawings

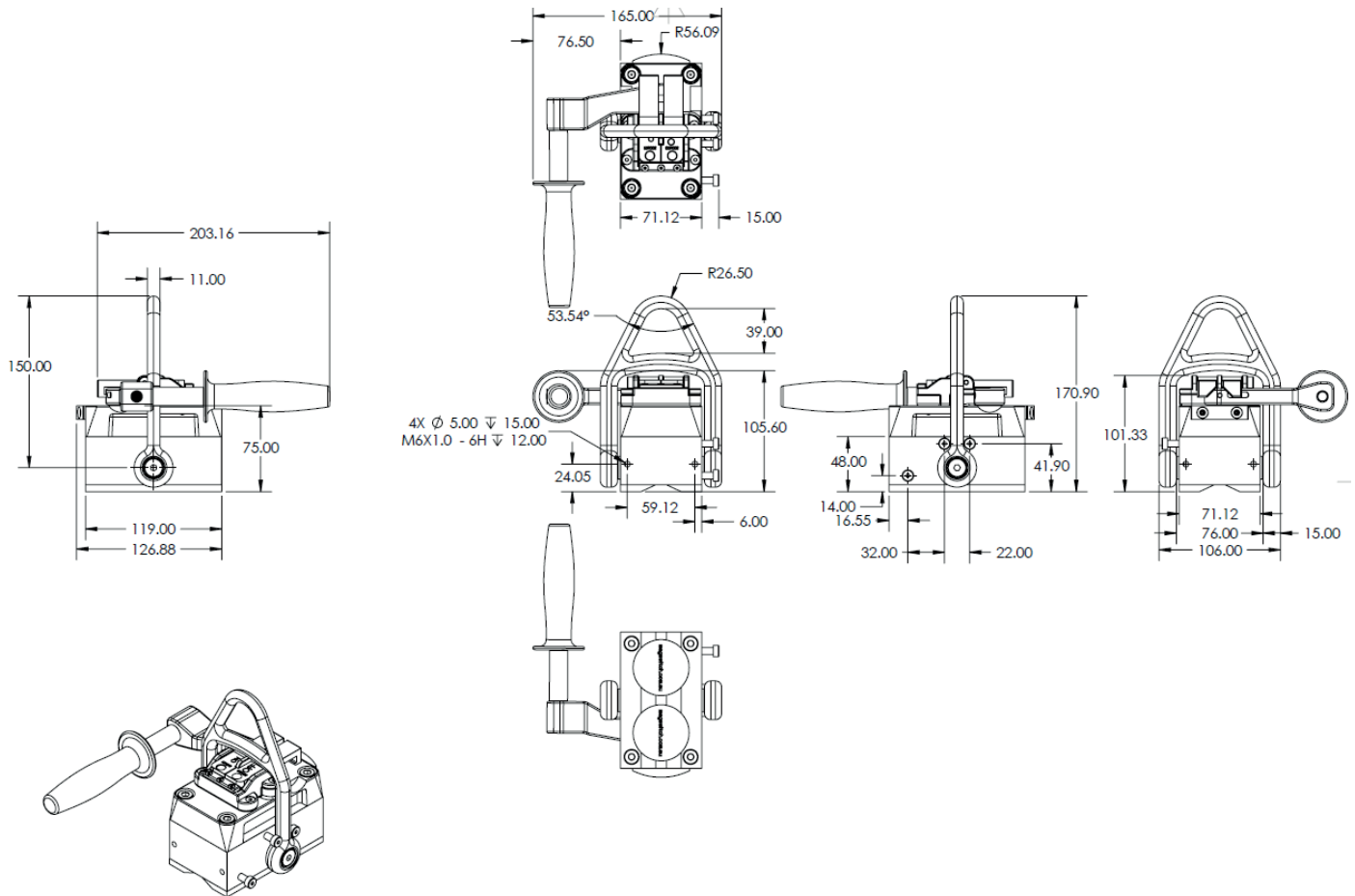

Magswitch Technologies | 1000 S. McCaslin Blvd.  
Suite 301 | Superior | Colorado 80027  
+1 (303) 468.0662 | sales@magswitch.com

MSA Magnetics | 14250 Judicial Road  
Burnsville, MN | 55306 | 651-272-2950  
sales@msamagnetics.com

**MLAY600x2**  
**8100360**

Doc Num 01

Subject to technical and color changes. No liability for errors and misprints assumed. © Magswitch Technologies 2024

# MLAY600x2

P/N: 8100360

## Safe Working Load

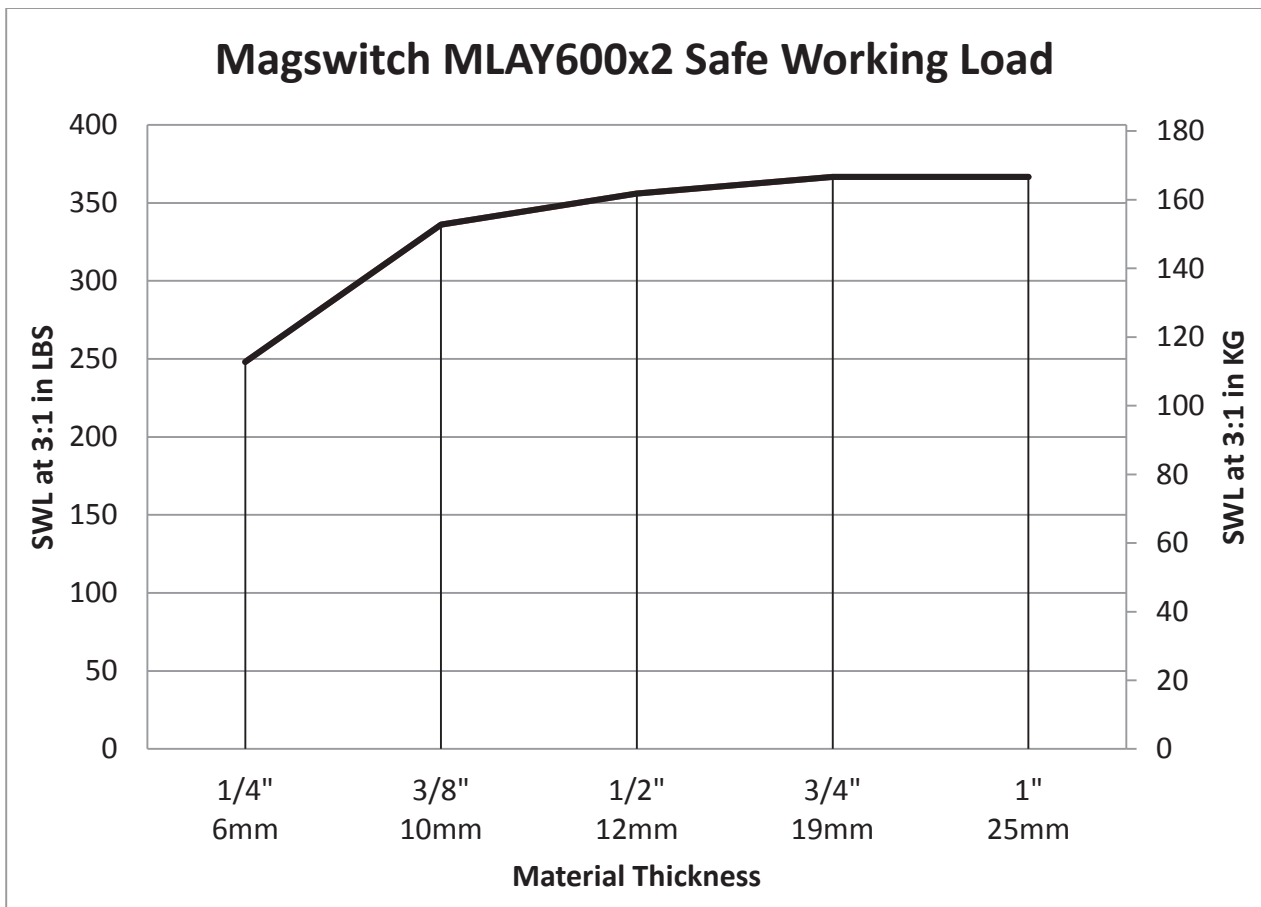

Magswitch Technologies | 1000 S. McCaslin Blvd.  
Suite 301 | Superior | Colorado 80027  
+1 (303) 468.0662 | sales@magswitch.com

MSA Magnetics | 14250 Judicial Road  
Burnsville, MN | 55306 | 651-272-2950  
sales@msamagnetics.com

**MLAY600x2**  
**8100360**

Doc Num 01

Subject to technical and color changes. No liability for errors and misprints assumed. © Magswitch Technologies 2024