



AT EVERY STEP OF THE WAY

MagMount 300

P/N: 8100595

Tool Features

The Magswitch MagMount 300 is a single lever operation switchable magnet that allows for easy movement and placement of a tool. It is ideal for mounting fixtures and attachments to a ferrous surface with strong hold. The actuation lever has a locking mechanism to avoid accidental release. Top threaded holes allow this to be a versatile magnetic mount.



WARNING!
DO NOT OPERATE UNLESS IN
CONTACT WITH FERROUS TARGET

Specifications

Max Breakaway *	246 lbs	111 kg
Full Saturation Thickness	3/16 in	4.75 mm
Net Weight	1.2 lbs	0.5 kg
Overall Height	1.7 in	43.8 mm
Magnetic Pole Footprint	71.8 x 51.5 mm	



WORKING SURFACE
BLACK=BEST
GRAY=MODERATE

* Max Breakaway determined in laboratory environment on 2" thick SAE1018 Steel with surface roughness 63 micro inches. Many factors contribute to the actual breakaway force in each application. Always test the magswitch in each application before deployment. Refer to the magswitch information booklet for more information.



Magswitch Technologies | 1000 S. McCaslin Blvd.
Suite 301 | Superior | Colorado 80027
+1 (303) 468.0662 | sales@magswitch.com

MSA Magnetics | 4 Prince of Wales Ave
Unanderra NSW | 2526 | +61 2 4272 8180
sales@msamagnetics.com.au

MAGMOUNT 300
8100595

Doc Num 01

Subject to technical and color changes. No liability for errors and misprints assumed. © Magswitch Technologies 2024

MagMount 300

P/N: 8100595

Drawings

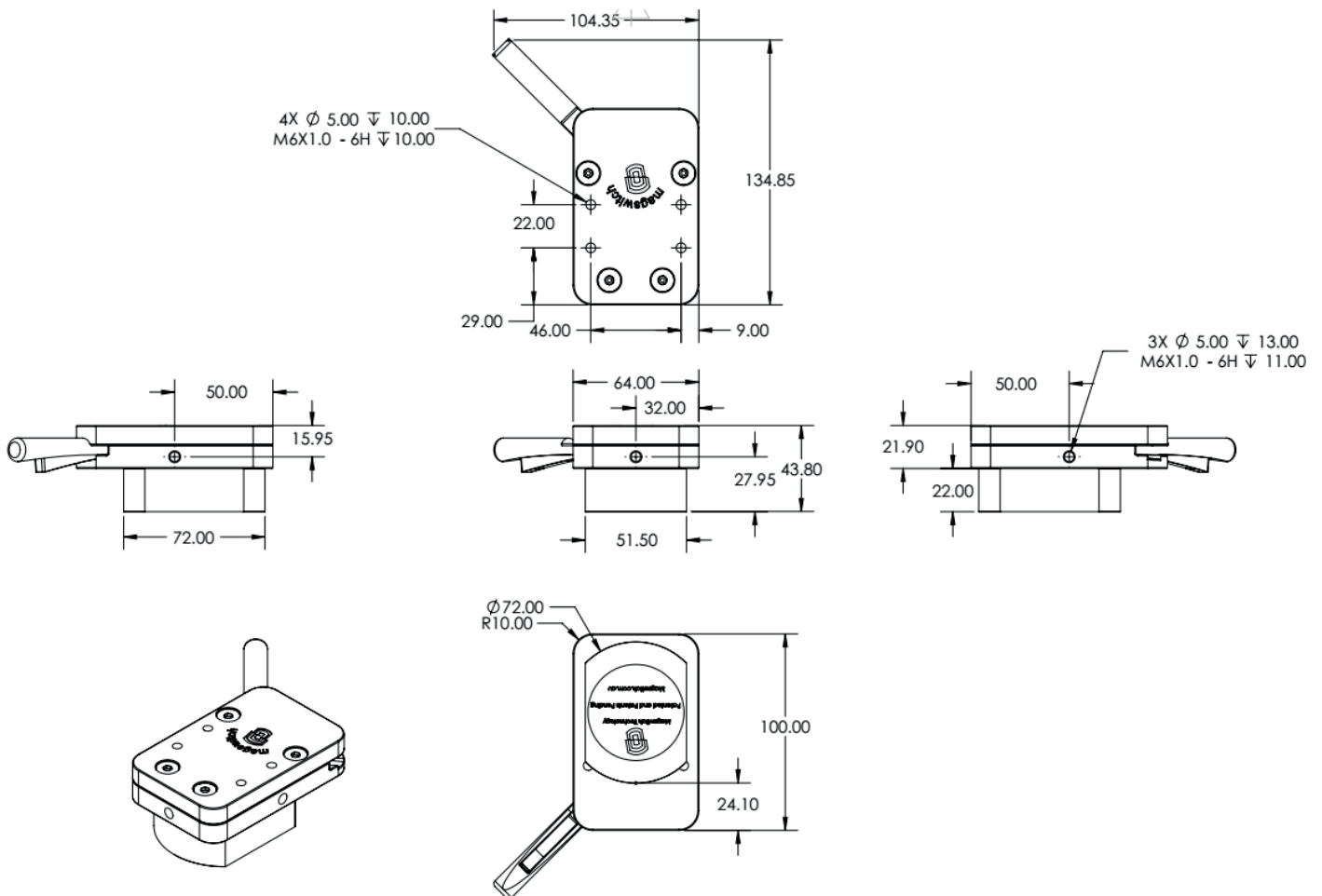

Magswitch Technologies | 1000 S. McCaslin Blvd.
Suite 301 | Superior | Colorado 80027
+1 (303) 468.0662 | sales@magswitch.com

MSA Magnetix | 4 Prince of Wales Ave
Unanderra NSW | 2526 | +61 2 4272 8180
sales@msamagnetix.com.au

MAGMOUNT 300
8100595

Doc Num 01

Subject to technical and color changes. No liability for errors and misprints assumed. © Magswitch Technologies 2024

MagMount 300

P/N: 8100595

Breakaway Data

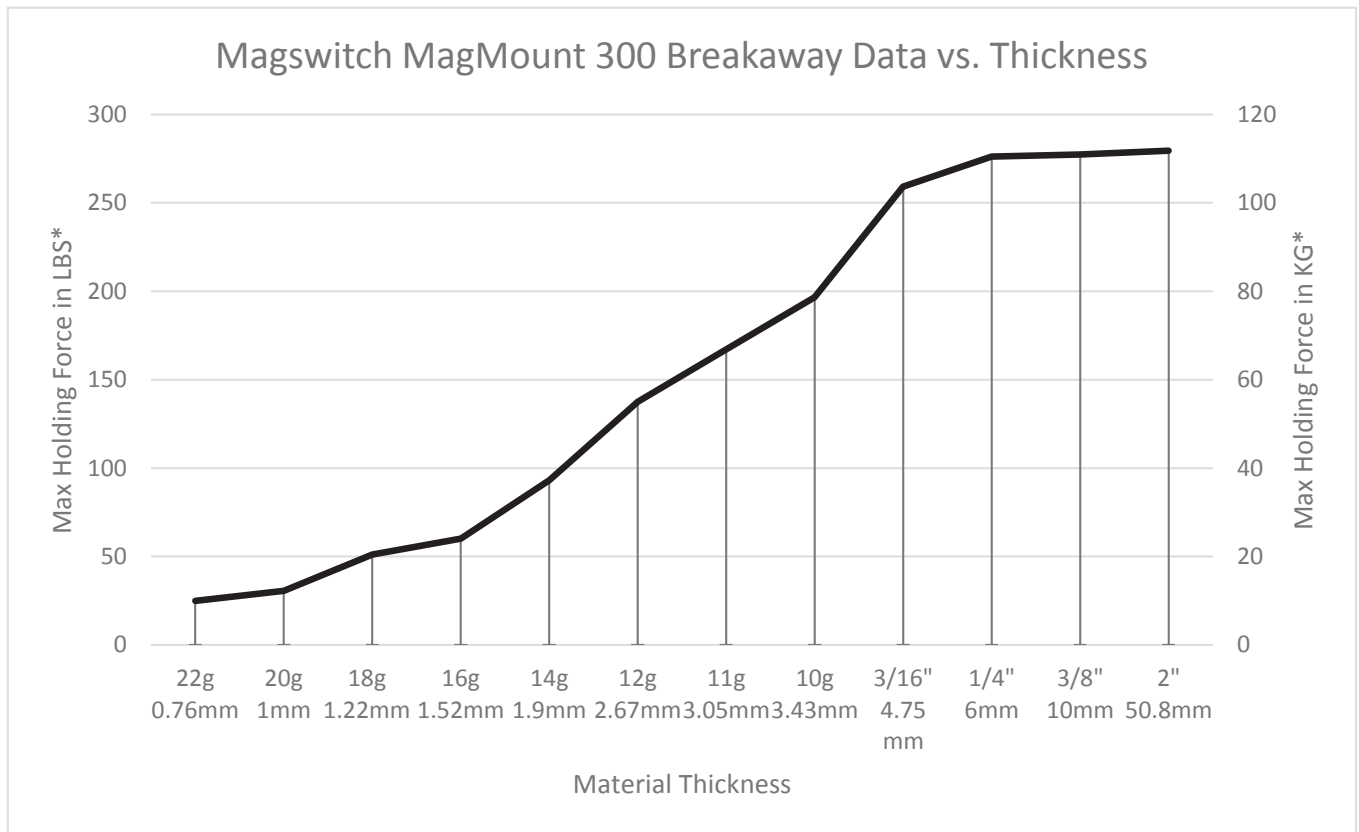

* Max Breakaway determined in laboratory environment on 2" thick SAE1018 Steel with surface roughness 63 micro inches. Many factors contribute to the actual breakaway force in each application. Always test the magswitch in each application before deployment. Refer to the magswitch information booklet for more information.



Magswitch Technologies | 1000 S. McCaslin Blvd.
Suite 301 | Superior | Colorado 80027
+1 (303) 468.0662 | sales@magswitch.com

MSA Magnetics | 4 Prince of Wales Ave
Unanderra NSW | 2526 | +61 2 4272 8180
sales@msamagnetics.com.au

MAGMOUNT 300
8100595

Doc Num 01

Subject to technical and color changes. No liability for errors and misprints assumed. © Magswitch Technologies 2024